

# Rear Suspension

## Knuckle/Hub Replacement-4WS (cont'd)

11. Remove the cotter pin from the tie-rod end and remove the castle nut.
12. Break loose the tie-rod ball joint using the special tool, then lift the tie-rod out of the knuckle.

**CAUTION:** Avoid damaging the ball joint boot.

**BALL JOINT REMOVER**  
07941-6920003

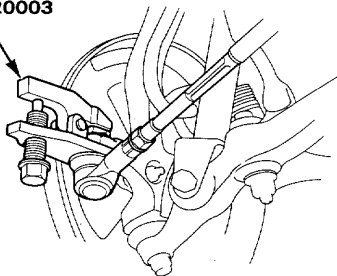

**BALL JOINT NUT  
(CASTLE NUT)**  
44 N·m  
(4.4 kg-m, 32 lb-ft)

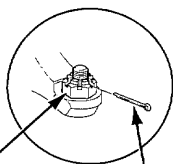

**PIN**

Replace.

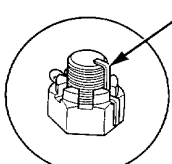

On reassembly,  
bend the pin as shown.

13. Pry the cotter pin off and loosen the lower arm ball joint nut half the length of the joint threads.
14. Separate the ball joint and lower arm using a puller with the pawls applied to the lower arm.

**CAUTION:** Avoid damaging the ball joint boot.

Hang puller  
pawls on lugs  
on lower arm.

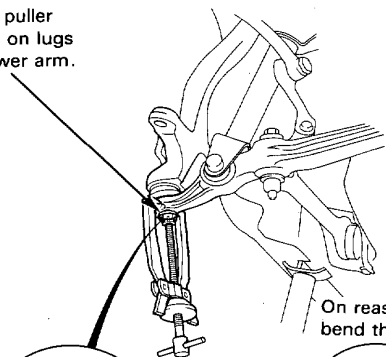

On reassembly,  
bend the pin as shown.

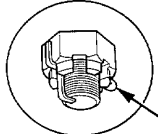

**PIN**

**PIN**  
Replace.

**BALL JOINT NUT  
(CASTLE NUT)**  
55 N·m (5.5 kg-m, 40 lb-ft)

15. Remove the cotter pin and the upper ball joint nut.
16. Break loose the upper ball joint using the special tool, then remove the knuckle.

**NOTE:** If necessary, apply penetrating type lubricant to loosen the ball joint.

**CAUTION:** Avoid damaging the ball joint boot.

**BALL JOINT  
REMOVER**  
07941-6920003

**KNUCKLE  
PROTECTOR**

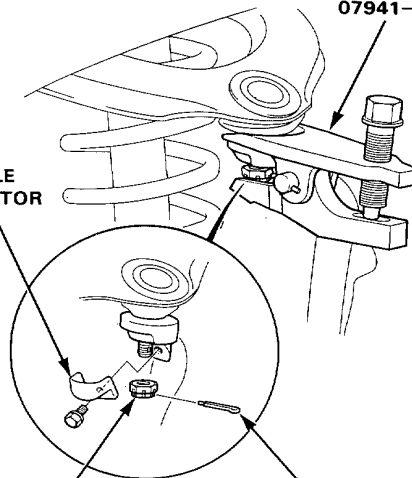

**BALL JOINT NUT  
(CASTLE NUT)**  
44 N·m (4.4 kg-m, 32 lb-ft)

**PIN**

Replace.

17. Remove the spindle from the knuckle.

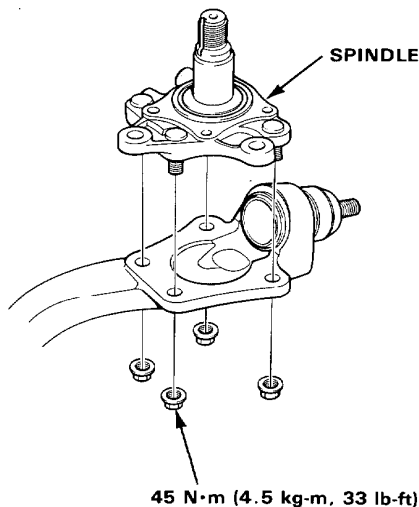

45 N·m (4.5 kg-m, 33 lb-ft)

18. Install in the reverse order of removal. Tighten the new spindle nut to specified torque, then stake the nut.